

Elite 100 V2

Portable Power Station

User Manual v3.1

Important Instructions

For optimal performance, update your unit to the latest firmware before first use.

See the appendix "Update Firmware via BLUETTI App" for guidance.

Read and understand this manual before use and keep it handy for future reference.



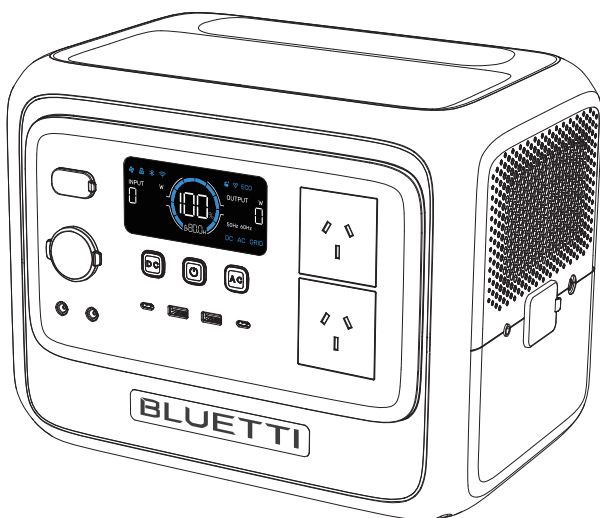

⚠ Tips

1. Fully charge the unit before first use.
2. Do not use solar panels with open circuit voltage higher than 60V. Solar input voltage range for the unit is 12V-60V.
3. If the unit's SoC falls below 5%, please recharge the unit in time. If the SoC drops to 0, power off the unit and charge it for at least 30 minutes before restarting.
4. Do not connect the unit's AC output to the grid.
5. If not used for more than 3 months, charge the unit to 40%-60% SoC and store it with the power off.
6. For optimum battery life, discharge and charge the unit every 3 months.

Legal Information

Copyright © 2025 Shenzhen PowerOak Newener Co., Ltd. All rights reserved.

No part of this document may be reproduced or transmitted in any form or by any means without the prior written consent of Shenzhen PowerOak Newener Co., Ltd.

Notice

BLUETTI's products and services are subject to the terms and conditions agreed upon during purchase. Some aspects described in this manual may not be available under your purchase contract. Unless otherwise specified in the contract, BLUETTI makes no express or implied representations or warranties regarding the contents of this manual.

The contents of this manual are subject to change without notice. Please obtain the latest version from BLUETTI official website.

If you have any questions or concerns about this manual, please contact BLUETTI support for further assistance.

Shenzhen PowerOak Newener Co., Ltd.

19F, Block A, Kaidaer Bldg., No.168 Tongsha Rd, Shenzhen, China

Website: <https://www.bluettipower.com/>

Contents



1	Safety Information	05
2	What's in the Box	08
3	Get to Know Your Elite 100 V2	09
3.1	Elite 100 V2 Overview	09
3.2	LCD Display	10
4	Use Your Elite 100 V2	11
4.1	Power On/Off	11
4.2	Charging Options	12
4.3	Power Your Devices	14
5	Configure Your Elite 100 V2	15
5.1	Setting Mode	15
5.2	AC Charging Mode	16
5.3	Power Lifting Mode	16
5.4	ECO Mode	16
6	Viewing Device Information	17
7	UPS Feature	17
8	Grid Self-Adaption Mode	19
9	Maintenance and Care	20
10	Specifications	21
11	Troubleshooting & FAQs	22
	Appendix	23
	Compliance	26

1. Safety Information

INSTRUCTIONS PERTAINING TO RISK OF FIRE, ELECTRIC SHOCK, OR INJURY TO PERSONS

WARNING - When using the product, basic precautions should always be followed, including the following:

- Read all the instructions before using the product.
- Handle the product with care, avoiding drops, violent impacts, or tilting.
- To reduce the risk of injury, close supervision is necessary when the product is used near children.
- Do not put fingers or foreign objects into the product's ports.
- Use of an attachment not recommended or sold by the manufacturer may result in a risk of fire, electric shock, or injury to persons.
- Do not move the product during operation to avoid poor connections.
- Do not expose the battery to high temperatures, as this may cause an explosion or leakage of flammable liquids or gases.
- Do not use the product in the rain or high humidity environments.
- Do not use a battery pack or appliance that is damaged or modified. Damaged or modified batteries may exhibit unpredictable behavior resulting in fire, explosion, or risk of injury.
- Handle the product with caution in low air pressure environments to prevent explosions or leaks.
- Charge the product in a well-ventilated area.
- Under abusive conditions, liquid may be ejected from the product's battery; avoid contact. If contact accidentally occurs, flush with water. If liquid contacts eyes, additionally seek medical help. Battery liquid may cause irritation or burns.
- In case of fire, use a dry powder fire extinguisher appropriate for the product.
- Never dispose of the product's battery in fire, hot ovens, or by cutting it.
- Do not operate the product with a damaged cord, plug, or output cable.
- To reduce the risk of damage to the electric plug and cord, pull the plug rather than the cord when disconnecting the product.
- Do not disassemble the product; take it to a qualified service person if service or repair is required. Incorrect reassembly may result in a risk of fire or electric shock.
- Unplug the product before any servicing to reduce the risk of electric shock.
- **WARNING - RISK OF EXPLOSIVE GASES.** Follow these instructions and those published by manufacturer of any equipment you intend to use in vicinity of the product to reduce risk of battery explosion.

- **WARNING - RISK OF ELECTRIC SHOCK.** Never use the product to power tools to cut or access live parts, wirings, or materials containing them, such as building walls.
- Have servicing performed by a qualified repair person using only identical replacement parts. This will ensure that the safety of the product is maintained.
-   The symbols on the unit and its accessories are intended to remind you to read the instructions in the literature accompanying the product before operation and maintenance.
- The socket-outlet should be installed near the product and easily accessible for safety purposes.
- **Caution:** The output of USB-C, DC5521, and cigarette lighter ports are classified as PS3 according to standard IEC 62368-1. Consider implementing safeguards against fire, such as a fire enclosure, for connected equipment or accessories.

Attention



Not permitted on aircraft.

- When charging with lead-acid batteries or using the product to charge them, follow these safety precautions:
 - a. Wear complete eye and clothing protection; do not touch eyes when working near a battery.
 - b. No smoking, sparks, or flames near the battery or engine.
 - c. Avoid dropping metal tools onto the battery to prevent sparks or short circuits.
- RFID is for internal manufacturer upgrades only.

Disposal and Recycling

1. Take old electronic components and batteries to designated recycling centers. This prevents improper disposal and supports material recovery.
2. If possible, fully discharge the batteries and then place them in designated battery recycling boxes. The batteries in this product contain hazardous chemicals. Do not dispose of them with regular household waste. Please follow local laws and regulations for proper battery disposal.
3. If a battery cannot fully discharge due to product malfunction, do not place it in the battery recycling box. Instead, contact a professional battery recycling organization for safe handling.

Grounding Instructions (For AC charging only)

- This product must be grounded when connected to the grid. If this product should malfunction, grounding provides a path of least resistance for electric current to reduce the risk of electric shock.
- The product is equipped with an AC charging cable having an equipment grounding conductor and a grounding plug. The plug must be plugged into an appropriate outlet that is properly installed and grounded in accordance with all local codes and ordinances.
- **WARNING** - Improper connection of the grounding conductor can result in a risk of electric shock. Check with a qualified electrician if you're in doubt as to whether the product is properly grounded. Don't modify the plug provided with the product - if it'll not fit the outlet, have a proper outlet installed by a qualified electrician.

SAVE THESE INSTRUCTIONS

2. What's in the Box

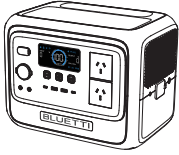

Elite 100 V2
Portable Power Station

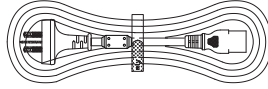

AC Charging Cable
(59.06in / 1.5m)



Grounding Screw
(M5*10)



Documentation

The following accessories are not included.

Please purchase optional accessories at <https://www.bluettipower.com>

Note: All images are for reference only.

Optional Accessories



Lead-acid Battery Charger*
Cig lighter plug to Clamps
(19.69in / 0.5m)



Car Charging Cable
Cig lighter plug to XT60-F
(28.35in / 0.72m)

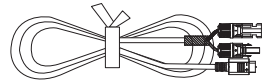

Solar Charging Cable
MC4 to XT60
(59.06in / 1.5m)

* Used to charge 12V car battery using Elite 100 V2's cigarette lighter port.

3. Get to Know Your Elite 100 V2

3.1 Elite 100 V2 Overview

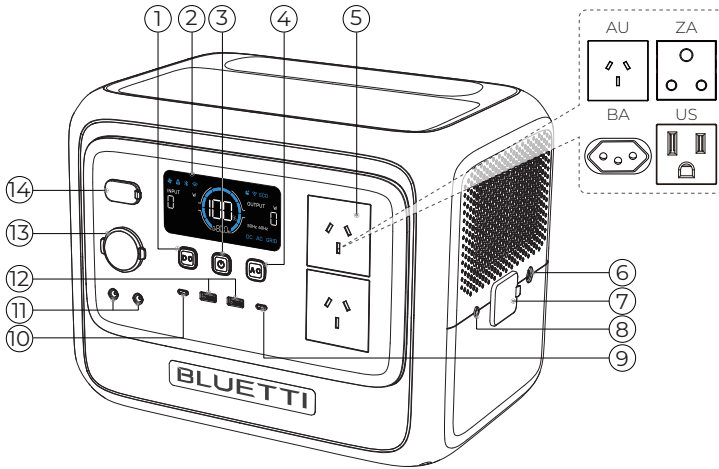

- ① DC Power Button
- ② LCD Display
- ③ Power Button
- ④ AC Power Button
- ⑤ AC Outlets
- ⑥ Circuit Breaker
- ⑦ AC Input
- ⑧ Grounding Terminal*
- ⑨ 100W USB-C Port
- ⑩ 140W USB-C Port
- ⑪ DC5521 Ports
- ⑫ USB-A Ports
- ⑬ Cigarette Lighter Port (Car Outlet)
- ⑭ DC Input

* Used for grounding when powering certain appliances. For assistance, contact us or seek guidance from the appendix "Grounding Guidelines".

3.2 LCD Display

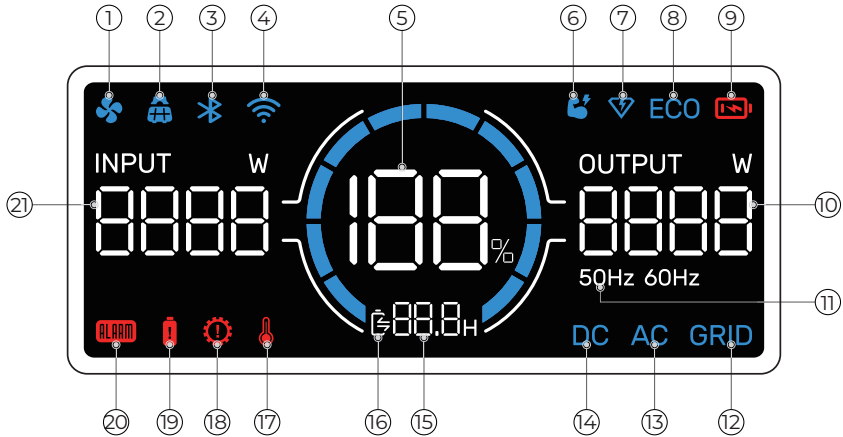

- | | | |
|--------------------------|-----------------------|-------------------|
| ① Fan* | ⑧ ECO Mode | ⑮ Remaining Time* |
| ② DC Input* | ⑨ Low Battery* | ⑯ Battery Status* |
| ③ Bluetooth | ⑩ Output Power* | ⑰ Temp Alert |
| ④ WiFi | ⑪ AC Output Frequency | ⑱ Overload |
| ⑤ State of Charge (SoC)* | ⑫ AC Input* | ⑲ Short Circuit |
| ⑥ Power Lifting Mode | ⑬ AC Output* | ⑳ System Fault |
| ⑦ Turbo Charging | ⑭ DC Output* | ㉑ Input Power* |

* Fan: Flashes when the fan is malfunctioning.

DC Input: Shows Elite 100 V2 charges via solar panels, cars, or lead-acid batteries.

State of Charge (SoC): The progress bar fills up while charging and depletes while discharging.

Low Battery: SoC below 5%. Charge the unit in time.

Output/Input Power: Total AC and DC discharging or charging power.

AC Input: Shows Elite 100 V2 charges via wall outlet or generator.

AC/DC Output: Indicates active output.

Remaining Time: Shows the time remaining for charging or discharging.

Battery Status:  for charging,  for discharging.

4. Use Your Elite 100 V2

4.1 Power On/Off

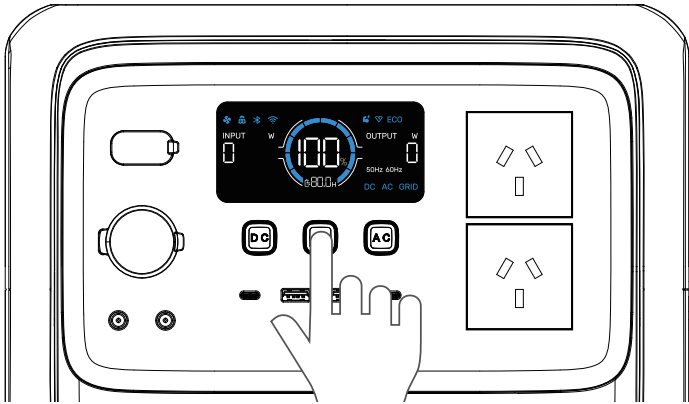

Power On

Press the power button; the lit button indicates that the Elite 100 V2 is on standby.

Power Off

Long press the power button for about 2 seconds to turn off the unit.

AC On/Off

Press AC power button when Elite 100 V2 is on.

DC On/Off

Press DC power button when Elite 100 V2 is on.

Note: When Elite 100 V2 is on, press any button to activate the LCD display.

4.2 Charging Options

4.2.1 Wall Outlet

Plug the Elite 100 V2 into a standard wall outlet. It stops charging when fully charged.

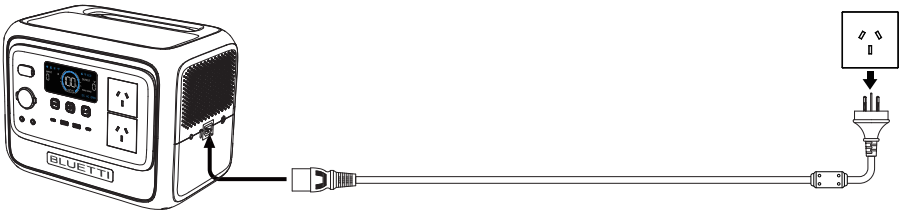

Note: Do not plug the unit's AC charging cable into its own AC outlets, as this could damage the connected device.

4.2.2 Solar Panel

Connect the solar panel(s) either in series or parallel, and use the solar charging cable to link them to Elite 100 V2.

Notes:

- Make sure your solar panel(s) meet the following requirements:
Voc: 12V-60V Current: 20A Max. Power: 1,000W Max.
- For dual solar charging, use both sets of the cable's MC4 connectors. They will be connected in parallel. Ensure both sets have the same power rating and type of solar panels.
For example, if one set has two 200W (20V/10A) panels in series, the other set should also have two 200W (20V/10A) panels of the same type in series.

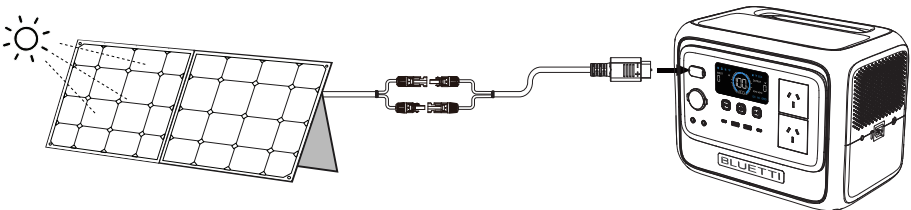

4.2.3 Car

Connect the Elite 100 V2 to your car's 12V or 24V cigarette lighter port using the car charging cable.

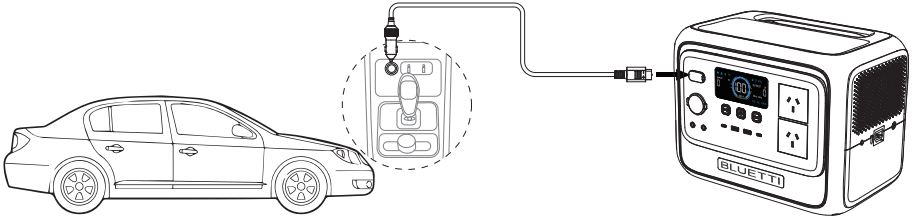

Note: Make sure your car has power and the engine is running while charging to prevent over-discharging the car battery.

4.2.4 Generator

Connect the Elite 100 V2 to a generator using the AC charging cable. The charging stops automatically when fully charged.

- Notes:**
- Make sure the generator delivers a pure sine wave output with matching voltage and frequency.
 - Ensure the generator's output power exceeds the Elite 100 V2's charging requirements.
 - It's recommended to enable the Grid Self-Adaption mode when charging the Elite 100 V2 with a generator.
 - If the generator's power is lower than the charging power, lower the Elite 100 V2's Max. Grid Charging Current in the app to ensure successful charging.

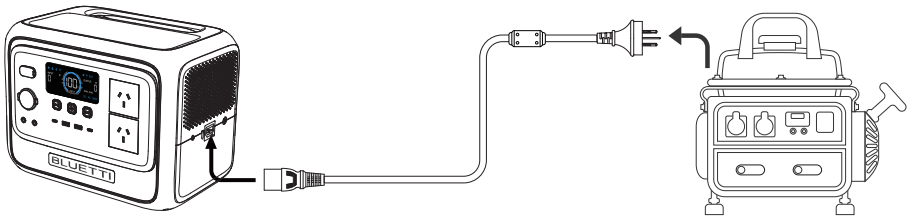

4.3 Power Your Devices

AC Outlets

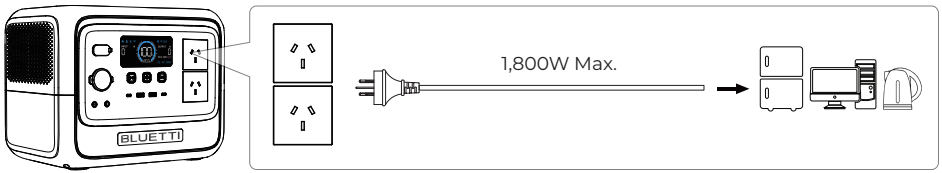

Note: When servicing the devices connected to the unit, remember to unplug them from the outlets. Even if the AC output is turned off, physically unplugging the devices is necessary for complete disconnection.

DC Outlets

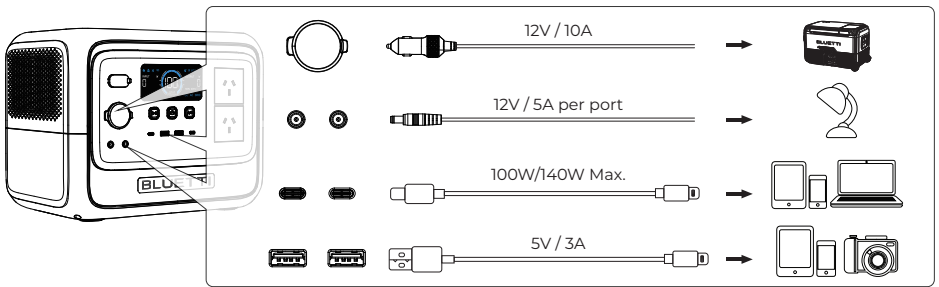

5. Configure Your Elite 100 V2

Use the buttons on the unit or the app to switch frequencies, toggle WiFi and Bluetooth, and activate modes like Power Lifting, Turbo Charging, and ECO. For advanced settings and features - such as Grid Self-Adaption mode, UPS mode, adjusting maximum grid input current, and detailed ECO mode settings - use the BLUETTI app. Refer to the app manual for more details.

5.1 Settings Mode

Enter the Mode: Press and hold the AC and DC power buttons simultaneously for about 2 seconds. The frequency icon flashes.

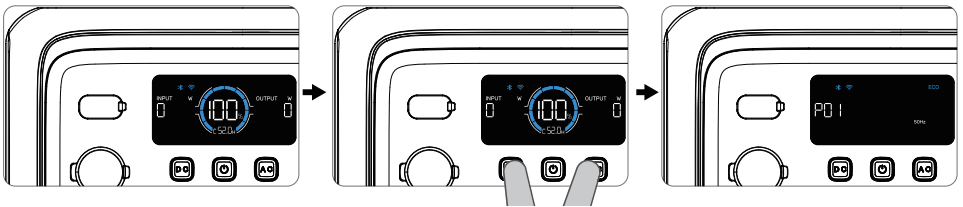

Exit the Mode: Press and hold both the AC and DC power buttons again.

If left idle for 1 minute, the Elite 100 V2 automatically exits without saving any changes.

Adjust settings in Settings Mode.

- Turn off AC output before setting the frequency.
- Press the DC power button to navigate through the items, and press the AC power button to adjust.

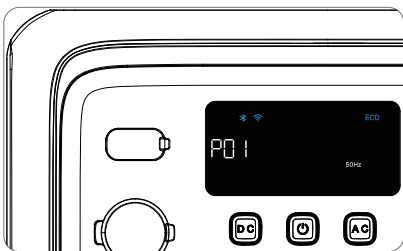

Page Code	Setting
P01	Frequency
P03	Charging Mode
P04	Power Lifting Mode
P05	ECO Mode
P06	Bluetooth
P07	WiFi

5.2 Charging Mode

The Elite 100 V2 offers three AC charging modes: Standard, Turbo, and Silent. Set Standard and Turbo modes directly on the display, and use the app to activate Silent mode. By default, the unit charges in Standard mode.

Mode	AC Input	Solar Input	AC + Solar Input	AC Charging Time (Estimated)	Note
Standard	600W Max.	600W Max.	600W Max.	2 hrs	Battery-friendly
Turbo	1,200W Max.	1,000W Max.	1,200W Max.	80% in 45 mins	Quick recharge
Silent	600W Max.	600W Max.	600W Max.	2 hrs	Quiet operation

Note: The data above is for reference only. Charging time may vary depending on the environment.

5.3 Power Lifting Mode

Power Lifting Mode is disabled by default. It allows the Elite 100 V2 to power up to 2,700W pure resistive loads like kettles, electric blankets, hairdryers, and similar heating devices.

Note: This mode is only for pure resistive loads rated 1,800W-2,700W. While the Elite 100 V2 can handle such loads, its actual output power is still 1,800W.

5.4 ECO Mode

When ECO modes are turned on, please be cautious that the Elite 100 V2 will shut off the AC or DC output after a period of low or no load.

Set the shutdown power threshold (AC-ECO: 10–40 W, DC-ECO: 5–20 W) and auto-off time (1–4 hours) through the app.

AC-ECO and DC-ECO modes are disabled by default.

Notes:

- Both AC-ECO and DC-ECO modes are unavailable when charging with AC power or turn on the System Switch Recovery mode.
- Disable the ECO mode when connecting small devices or critical appliances such as lights and refrigerators.

6. View Device Information

View device information in Settings Mode, too.

- Go to the P01 frequency page and long press the DC power button to view the unit's SN. Press the DC power button again to navigate through other information.
- When on Fault History page, long press the AC power button for about 2 seconds, then release to clear the history.

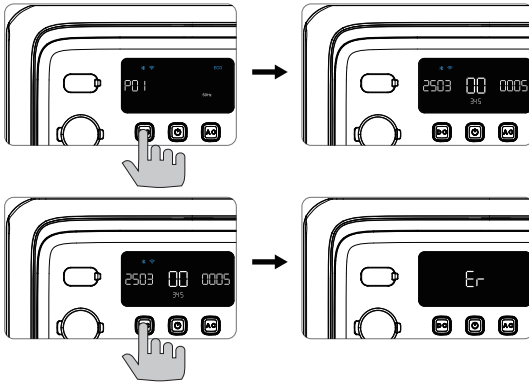

Page Code	Information
2503 00 0005	Serial Number (SN)
Er	Error Code
HI	Fault History
UE	Version

7. UPS Feature

Connect Elite 100 V2 to the wall, and it directly draws power from the outlet to operate connected devices. It swiftly switches to battery power within 10 ms during an outage. Set UPS modes in the app.

• Standard

Elite 100 V2 charges using available solar and grid power, with a priority on solar.

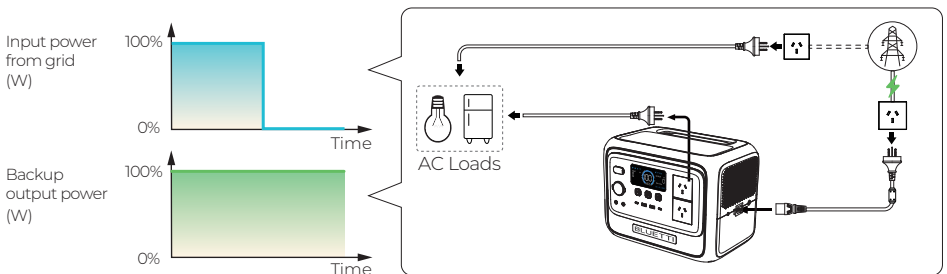

• Time Control

Save costs by scheduling Elite 100 V2 to charge during off-peak hours and power devices during peak hours.

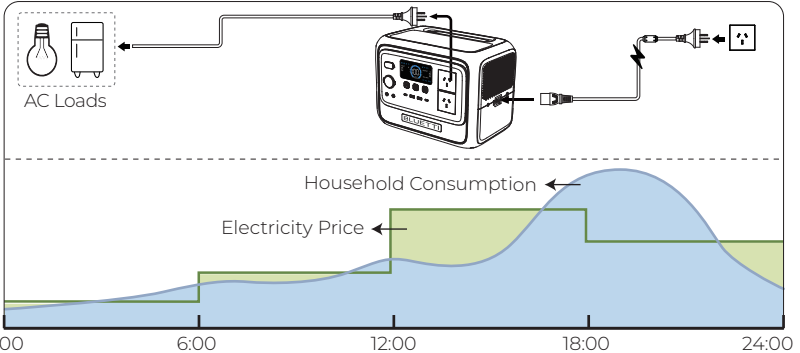

Period	Charge	Discharge	Discharge	Discharge
Load Power	Grid	Elite 100 V2 + PV	Elite 100 V2 + PV	Elite 100 V2

• PV Priority

Efficiently uses solar energy. Elite 100 V2 initially charges from the grid to a set SoC and seamlessly switches to solar replenishment.

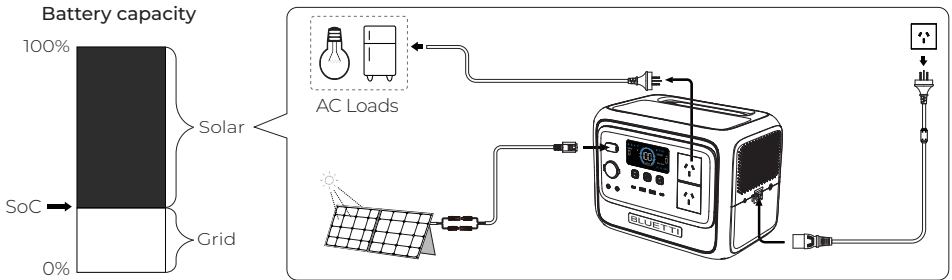

• Customized

Personalize charging/discharging schedule, set battery SoC limits, and control the schedule and grid input switches.

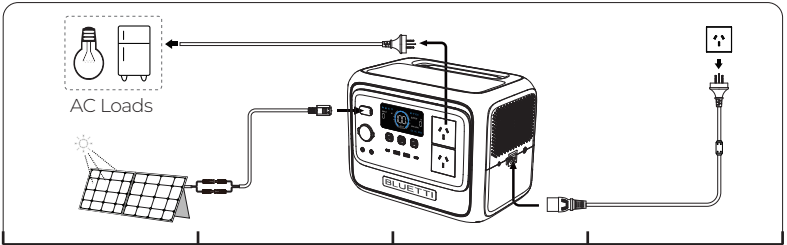

0:00 6:00 12:00 18:00 24:00

Period	Charge	Discharge	Discharge	Discharge
Load Power	Grid	Elite 100 V2	Elite 100 V2	Elite 100 V2

Attention: Not for devices like data servers or workstations that require high-performance UPS. BLUETTI assumes no liability for issues arising from violating this restriction.

8. Grid Self-Adaption Mode

When charging with an unstable generator or grid power, or if consumption power exceeds charging power, enable this mode in the app. The Elite 100 V2 automatically adjusts to handle power fluctuations, protecting the unit and connected devices from potential issues due to variations in power quality.

Unstable grid

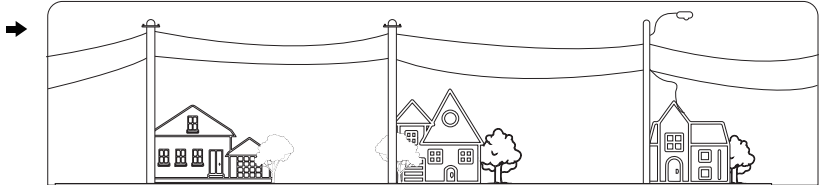

Unstable generator

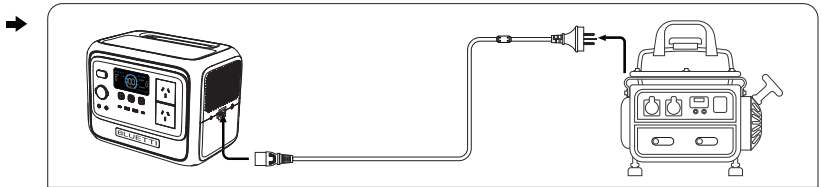

Charging and discharging

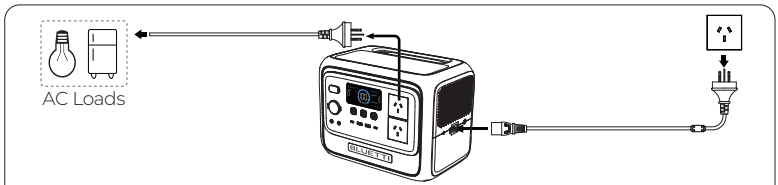

9. Maintenance and Care

- If the unit's SoC falls below 5%, please recharge the unit in time.
- Before storing, charge to 40%-60% SoC, then power off and disconnect all cables.
- Store it in a cool, dry place, away from flammable materials.
- Fully cycle every 3 months to maintain battery health.
- Avoid extended storage; it may impact performance and lifespan.

If SoC drops to 0 during storage or startup:

- Shut down immediately.
- Charge within 48 hours.
- Keep it at 5°C to 35°C (41°F to 95°F) for 6 hours before charging.
- Recommended to charge via an AC source; if using solar energy, ensure an input of over 100W.

10. Specifications

Model	Elite 100 V2
Battery Capacity	1,024Wh (20Ah)
Battery Type	LiFePO ₄
Weight	About 11.5kg (25.3lbs)
Dimensions (L × W × H)	320 × 215 × 250mm (12.6 × 8.5 × 9.8in)
Charging Temperature	0°C to 40°C (32°F to 104°F)
Discharging Temperature	-20°C to 40°C (-4°F to 104°F)
Working Humidity	10% to 90%
Noise	50dB Max.
AC Output	1,800W Max., 230V, 7.8A Max., 50Hz / 60Hz
DC Output	
1 × Cigarette Lighter Port	12V / 10A
2 × DC5521 Port	12V, total 8A Max., 5A per port
2 × USB-A	15W Max., 5V / 3A per port
1 × 100W USB-C	100W Max., 5V / 3A, 9V / 3A, 12V / 3A, 15V / 3A, 20V / 5A
1 × 140W USB-C	140W Max., 5V / 3A, 9V / 3A, 15V / 3A, 20V / 5A, 28V / 5A
AC + DC Output	1,900W Max.
AC Charging	1,200W Max. (80% in 45 mins @25°C / 77°F)
AC Input	2,300W Max. (Charging + Bypass)
DC Input	1,000W Max., 12V-60V, 20A Max.
AC + DC Charging	1,200W Max.
Uninterruptible Power Supply (UPS)	
Switchover Time	≤10 ms

Note: The cigarette lighter port and DC5521 ports are wired in parallel with a total maximum output of 10A.

11. Troubleshooting & FAQs

On the Error Code page, the **Ef** and error code appears simultaneously on the display. See the table below for guidance.

Error Code	Description	Solutions
E001	Inverter overload	<ul style="list-style-type: none">• Check device power usage.• Reduce load if too high.
E002	Inverter overtemperature, AC output off	<ul style="list-style-type: none">• Wait 10 mins for the unit to cool down.• Turn on the AC output again.
E003	Inverter short circuit	<ul style="list-style-type: none">• Check devices for short circuits.• Disconnect and fix.
E033	PV overvoltage	<ul style="list-style-type: none">• Make sure the PV input voltage is within 12V-60V.
E039	PV overtemperature	<ul style="list-style-type: none">• Wait 10 mins for the unit to cool down.• Re-enable the PV input.
E065	DC output short circuit	<ul style="list-style-type: none">• Reduce the load.
E067	DC output overcurrent	<ul style="list-style-type: none">• Check device power usage.• Reduce load if too high.
E068	DC output overtemperature	<ul style="list-style-type: none">• Wait 10 mins for the unit to cool down.• Restart your devices.
E085	Charging temperature too high	<ul style="list-style-type: none">• Wait for the unit to cool down before using it again.
E086	Charging temperature too low	<ul style="list-style-type: none">• Place the unit in an ambient temperature range of 0°C to 40°C (32°F to 104°F).
E087	Discharging temperature too high	<ul style="list-style-type: none">• Wait for the unit to cool down before using it again.
E088	Discharging temperature too low	<ul style="list-style-type: none">• Place the unit in an ambient temperature range of -20°C to 40°C (-4°F to 104°F).
E115	Grid overfrequency	<ul style="list-style-type: none">• Verify home grid frequency.• Contact utility company if necessary.
E116	Grid underfrequency	<ul style="list-style-type: none">• Verify home grid frequency.• Contact utility company if necessary.
Others	/	<ul style="list-style-type: none">• Contact BLUETTI support for help.

FAQs (Frequently Asked Questions)

Q1: How do I know whether my devices will work with this product?

A: Keep the total AC power below 1,800W. Some devices with motors or compressors may start at 2-4 times their rated power, which could easily overload the Elite 100 V2.

Q2: Can I use third-party solar panels to charge this product?

A: Yes, you can use third-party solar panels with open circuit voltage of 12V-60V and MC4 connectors. Avoid mixing different types of solar panels.

Q3: Can it charge and discharge at the same time?

A: Yes, the Elite 100 V2 supports pass-through charging.

Q4: Why is the charging power often too low?

A: The built-in BMS adjusts the charging power based on battery temperature and SoC to protect the battery and extend its life.

Q5: How to calculate the operation time?

A: Operation time = Battery Capacity × DoD × η ÷ (Load + Elite 100 V2's Self-consumption)
Note: DoD (Depth of Discharge) is 90%. η (inverter efficiency) is over 90%. The Elite 100 V2 self-consumption is about 10W.

Q6: Why does a warning come up when using a diesel heating pump with the cigarette lighter port?

A: The pump may require more initial power to start. Use a compatible adapter to start and run the pump with our AC outlets.

Appendix

Update Firmware via BLUETTI App

Keeping firmware updated is IMPORTANT for optimal performance. For detailed instructions, refer to the app user manual in the app. Using the Elite 200 V2 upgrade as an example.

1. Download the BLUETTI app

Scan the QR code or search for "BLUETTI" in the App Store or Google Play to download the app.



2. Log in or sign up

Log in with a BLUETTI account. If there is no account, create one by following the on-screen instructions.

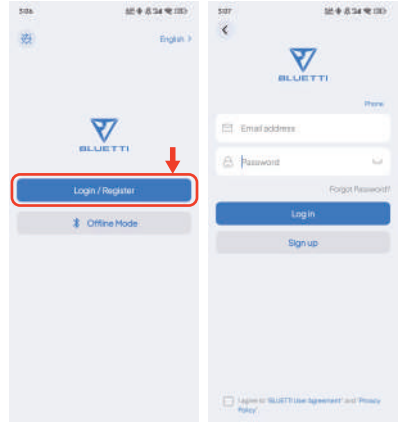

3. Bind the unit

- Tap Add Device directly or access My Devices > Add Device to start the process.
- Select the unit from the available device list, or choose Add Manually and enter the unit's serial number (SN).
- Alternatively, tap Scan on the Home page or in Add Device page to bind via QR code.

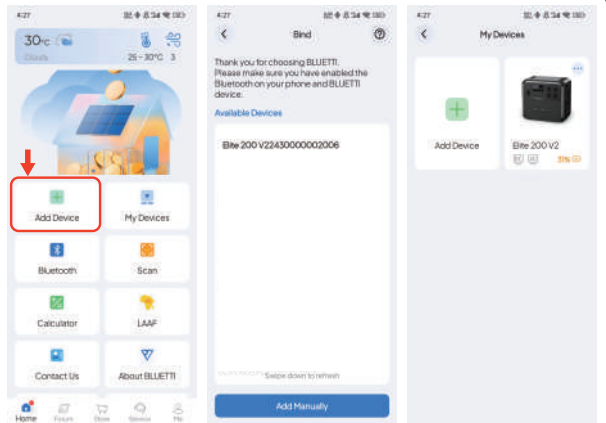

4. Connect via Bluetooth

On the My Devices page, tap the unit and select Bluetooth as the connection method.

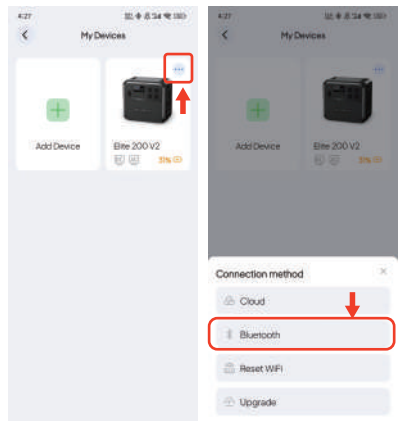

5. Check for Firmware Updates

Tap Upgrade to access the Upgrade page.

The app will check for the latest firmware version available for the unit.

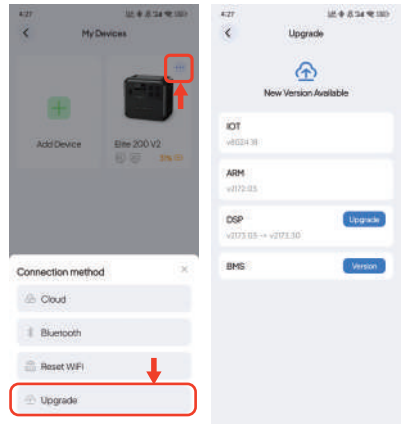

6. Download and Install the Update

If a new firmware update is available, tap

Upgrade and follow the on-screen instructions.

Notes:

- Ensure the unit remains powered on and connected during the update.
- Keep your phone and the unit close together (recommended range: 16.4ft / 5m).
- Do not exit app until done.

Grounding Guidelines

Only use the grounding terminal when the product is connected to the home grid using a 2-pin cable, or if the wall outlet's grounding is ineffective, and the connected device features a metal case.

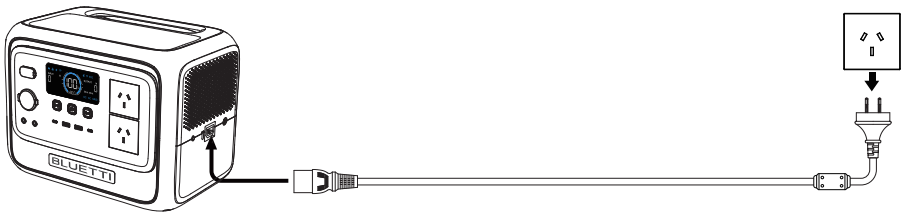

Use a cable with OT terminals for grounding. Connect one end to the grounding terminal with a grounding screw and the other end to the wall outlet or home distribution box ground.

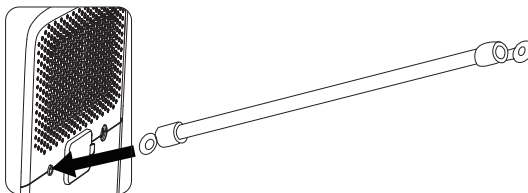

Need Help? We're here for you!

Customer Service(AU)

+61 8 89224712 (Monday to Friday: 9:00 - 12:00, 13:00 - 18:00 AEST)

Email: sale-au@bluettipower.com

Customer Service(ZA)

Email: sale-za@bluettipower.com



@ BLUETTI Official



@ bluetti_australia



@ bluetti.au



@bluetti.inc

Visit Us

SHENZHEN POWEROAK NEWENER CO., LTD.

Address: F19, BLD No.1, Kaidaer, Tongsha Rd No.168, Xili Street,
Nanshan, Shenzhen, China



BLUETTI

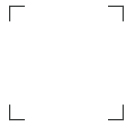

Certificate

Inspector: _____

QC: _____

Always Share Excellence

P/N: 17.0303.0880-03A3